



## SEC-301LFW-254x

(Special Edition Chemical gauge)

Our 'SEC-300LFW' series gauge line is a high quality line of all stainless steel liquid filled gauges. The stainless steel construction resists rust and corrosion while the glycerine filling helps dampen the effects of pulsation and vibration while perpetually lubricating the movement (keeping contaminants such as dirt away from all moving parts). These features will extend the life of the gauge.

This gauge has been specifically designed with the original equipment manufacturers in mind and are typically used on hydraulic & pneumatic systems in corrosive environments as well as any commercial or industrial application where 316SS wetted parts and glycerine filling is suitable for use.

### SPECIFICATIONS:

- **Dial Size:** 2 1/2"
- **Connection Size:** 1/4"MNPT
- **Stainless Steel Case And Bezel**
- **SS Internals**
- **316 SS Bourdon Tube & Connection**
- **Liquid Filled (Dry Available)**
- **Accuracy :** 1.5 %
- **Dual Scale: PSI & Bar (x100=kPa)**  
(Single Scale available)
- **Ambient temperature:** FILLED: 30°F to 160°F  
DRY: -30°F to 180°F



RANGE	CODE	Major In	Minor In
30/0"VAC	A	5	0.5
30/0/15	CB	5	0.5
30/0/30	CC	10	1
30/0/60	CD	10	1
30/0/100	CE	20	2
30/0/150	CF	20	2
30/0/300	CH	50	10
0/15	B	2	0.2
0/30	C	5	0.5
0/60	D	10	1
0/100	E	20	2
0/160	F	20	2
0/200	G	40	4
0/300	H	50	5
0/400	I	50	5
0/500	J	100	10
0/600	K	100	10
0/800	L	100	10
0/1000	M	200	20
0/1500	N	200	20
0/2000	O	400	50
0/3000	P	500	50
0/4000	Q	500	50
0/5000	R	1000	100
0/6000	S	2000	200
0/10,000	U	2000	200
0/15,000	V	2000	200

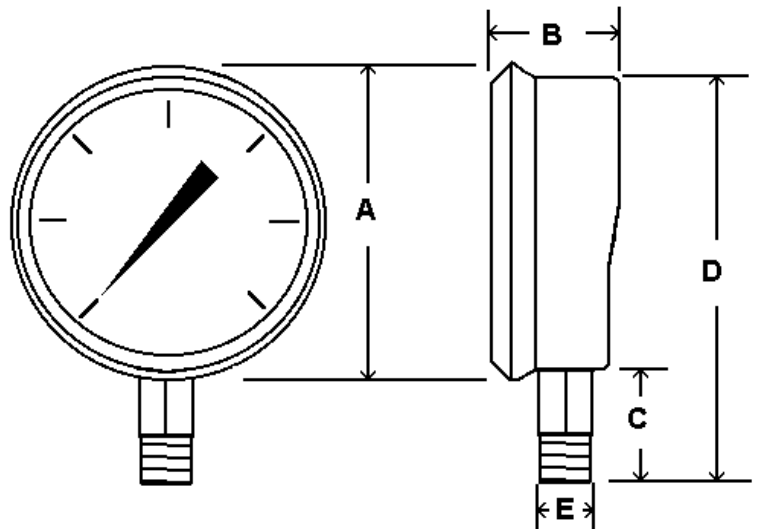

		A	B	C	D	E
2 1/2" Dial	In	2.80	1.28	1.07	3.55	1/4" Npt
	MM	71	33	27	90	